

PORTAVALIGIE LATERALE SPECIFICO - SPECIFIC TUBULAR SIDE-CASE HOLDER  
 PORTE-VALISES LATÉRAUX SPECIFIQUE - SPEZIFISCHES STAHLROHR-SEITENTRÄGER  
 PORTA MALETAS LATERALES ESPECIFICO

# YAMAHA FZ6 S2 / FZ6 S2 FAZER 2007

ISTRUZIONI DI MONTAGGIO - MOUNTING INSTRUCTIONS  
 INSTRUCTIONS DE MONTAGE - BAUANLEITUNG - INSTRUCCIONES DE MONTAJE



**1**  
**SUPPORTO**  
 SUPPORT  
 SUPPORT  
 HALTERUNG  
 SOPORTE

**Q.TY n.2(Dx-Sx)**



**2**  
**PONTE POSTERIORE**  
 REAR BRIDGE  
 PONT POSTÉRIEURE  
 VERBINDUNGSROHR  
 PUENTE TRASERO

**Q.TY n.1**

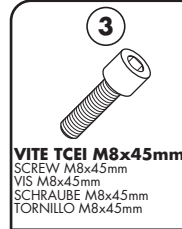

**3**  
**VITE TCEI M8x45mm**  
 SCREW M8x45mm  
 VIS M8x45mm  
 SCHRAUBE M8x45mm  
 TORNILLO M8x45mm

**Q.TY n.2**



**4**  
**VITE TSCEI M6x40mm**  
 SCREW M6x40mm  
 VIS M6x40mm  
 SCHRAUBE M6x40mm  
 TORNILLO M6x40mm

**Q.TY n.2**



**5**  
**FUNGHETTO Z125**  
 SIDE SUPPORT  
 CHAMPIGNON  
 KOPFER BEFESTIGUNGStoßSEL  
 BRIDA

**Q.TY n.2**



**6**  
**DADO SPECIALE**  
 V311  
 BOLT  
 ECROU  
 MUTTER  
 TUERCA

**Q.TY n.2**



**7**  
**GL 629**  
**FERMA FRECCIA**  
 BLINKER STOPPER  
 BLOQUE CLIGNOTANT  
 BLINKER BEFESTIGUNG  
 BLOQUEA INTERMITENTE

**Q.TY n.2**



**8**  
**SUPPORTO FRECCIA**  
 BLINKER SUPPORT  
 SUPPORT CLIGNOTANT  
 LAGER BLINKER  
 SOPORTE INTERMITENTE

**Q.TY n.2 (dx-sx)**

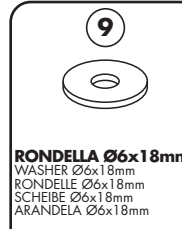

**9**  
**RONDELLA Ø6x18mm**  
 WASHER Ø6x18mm  
 RONDELLE Ø6x18mm  
 SCHEIBE Ø6x18mm  
 ARANDELA Ø6x18mm

**Q.TY n.4**

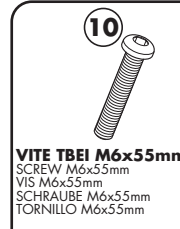

**10**  
**VITE TBEI M6x55mm**  
 SCREW M6x55mm  
 VIS M6x55mm  
 SCHRAUBE M6x55mm  
 TORNILLO M6x55mm

**Q.TY n.2**

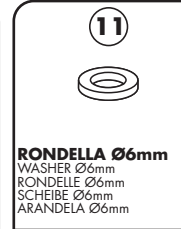

**11**  
**RONDELLA Ø6mm**  
 WASHER Ø6mm  
 RONDELLE Ø6mm  
 SCHEIBE Ø6mm  
 ARANDELA Ø6mm

**Q.TY n.2**

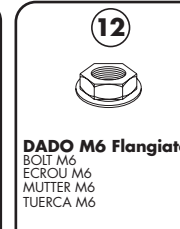

**12**  
**DADO M6 Flangiato**  
 BOIT M6  
 ECROU M6  
 MUTTER M6  
 TUERCA M6

**Q.TY n.4**

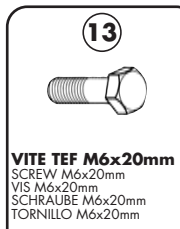

**13**  
**VITE TEF M6x20mm**  
 SCREW M6x20mm  
 VIS M6x20mm  
 SCHRAUBE M6x20mm  
 TORNILLO M6x20mm

**Q.TY n.4**



**14**  
**PIASTRINA GRANDE**  
 LITTLE PLATE  
 PETITE PLAQUE  
 PLAETTCHEN  
 PLAQUETA

**Q.TY n.2**

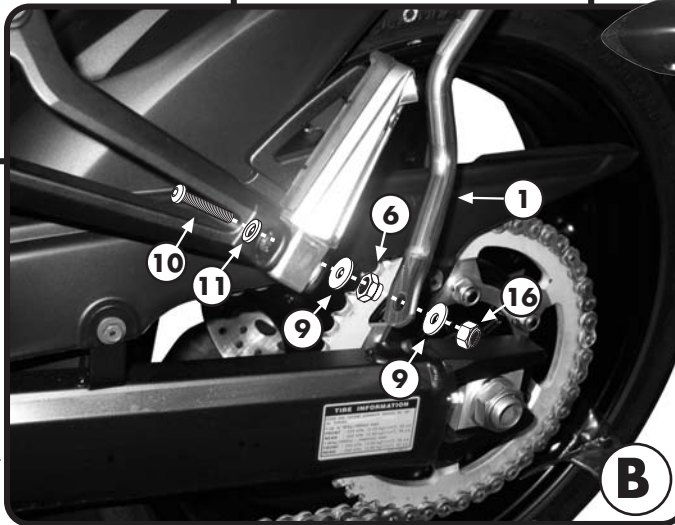
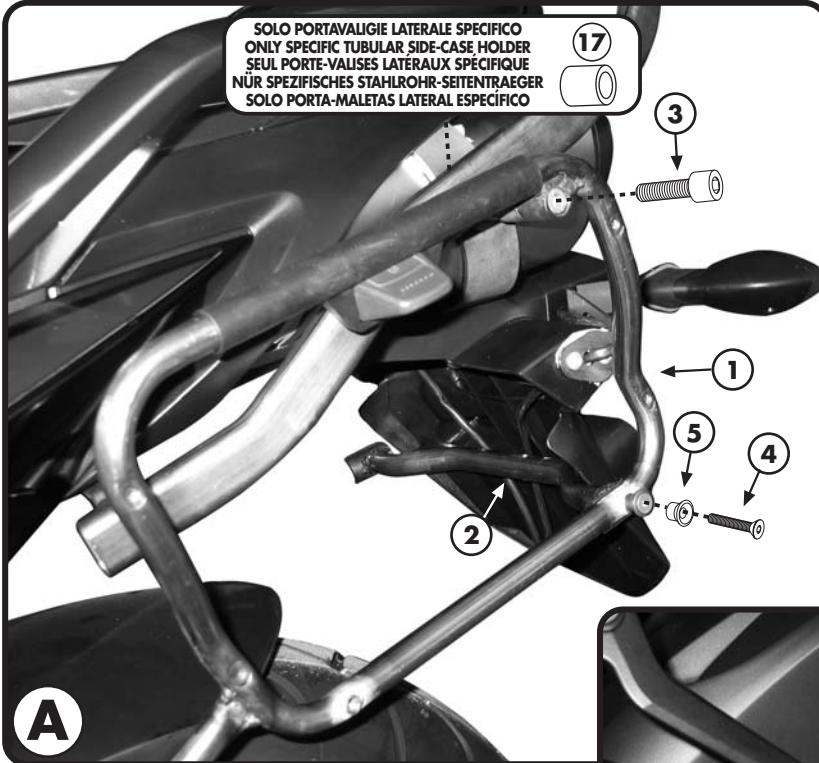
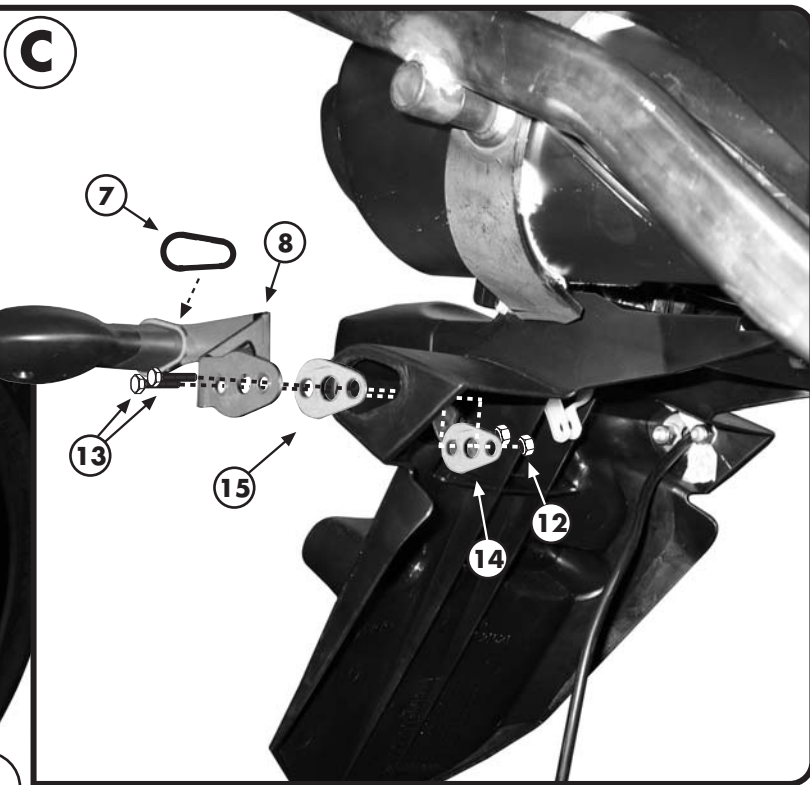

**15**  
**PIASTRINA PICCOLA**  
 LITTLE PLATE  
 PETITE PLAQUE  
 PLAETTCHEN  
 PLAQUETA

**Q.TY n.2**



**16**  
**DADO A.B. M6 NERI**  
 BOLT M6  
 ECROU M6  
 MUTTER M6  
 TUERCA M6

**Q.TY n.2**



**17**  
**DISTANZIALE Ø18x16mm**  
 Foro Ø8,5mm, V076  
 SPACER  
 ENTRETÔISE  
 DISTANZSTUECK  
 DISTANCIADOR

**Q.TY n.2**

PORTAVALIGIE LATERALE SPECIFICO - SPECIFIC TUBULAR SIDE-CASE HOLDER  
 PORTE-VAISES LATÉRAUX SPECIFIQUE - SPEZIFISCHES STAHLROHR-SEITENTRAEGER  
 PORTA MALETAS LATERALES ESPECIFICO

# YAMAHA FZ6 S2 / FZ6 S2 FAZER 2007

ISTRUZIONI DI MONTAGGIO - MOUNTING INSTRUCTIONS  
 INSTRUCTIONS DE MONTAGE - BAUANLEITUNG - INSTRUCCIONES DE MONTAJE

## I ISTRUZIONI DI MONTAGGIO

- POSIZIONARE I SUPPORTI "1" COME INDICATO IN FIGURA "A" ED ESEGUIRE IL MONTAGGIO PROPOSTO.  
 NEL CASO IN CUI SULLA MOTO NON SIA MONTATO IL MONORACK 351FZ, METTERE IL DISTANZIALE "17" TRA  
 IL SUPPORTO "1" E LA BOCCOLA SALDATA SUL 351KIT.  
 FISSARE IL PORTAVALIGIE ALLE PEDALINE SEGUENDO IL MONTAGGIO PROPOSTO IN FIGURA "B".

## GB MOUNTING INSTRUCTIONS

PLACE THE SUPPORTS N°1 AS SHOWN IN PICTURE A AND CARRY OUT THE SUGGESTED MOUNTING PROCEDURE. IF THE 351FZ MONORACK IS NOT ALREADY FITTED TO THE MOTORCYCLE, PLACE THE SPACER N°17 BETWEEN THE SUPPORT N°1 AND THE BUSH WELDED ON THE 351KIT (SOLD SEPARATELY). LASTLY FIX THE SIDE-CASE HOLDER TO THE FOOTREST FOLLOWING THE MOUNTING STEPS OF PICTURE B.

## F INSTRUCTIONS DE MONTAGE

POSITIONNER LES SUPPORTS "1" COMME INDIQUE EN PHOTO "A" ET EXECUTER LE MONTAGE PROPOSE. DANS LE CAS OU SUR LA MOTO IL N'Y A PAS DE MONORACK 351FZ, METTRE LA PIECE « 17 » ENTRE LE SUPPORT « 1 » ET LA BOUCLE SOUDEE SUR LE 351KIT. FIXER LE PORTE-VALISE AUX REPOSE-PIEDS PASSAGER EN SUIVANT LE MONTAGE PROPOSE EN PHOTO « B ».

## D BAUANLEITUNG

POSITIONIEREN SIE DIE HALTERUNGEN NR. 1 WIE IM BILD A BESCHRIEBEN UND FOLGEN SIE DER MONTAGE; FALLS AUF DEM MOTORRAD DAS 351FZ MONORACK NICHT MONTIERT WURDE, VERWENDEN SIE DAS DISTANZSTÜCK NR. 17 ZWISCHEN DER HALTERUNG NR. 1 UND DER GESCHWEIßTEN BUCHSE AUF DEM 351KIT. BEFESTIGEN SIE DEN SEITENKOFFERTRÄGER AN DEN FUßRASTEN MIT DEN MONTAGEHINWEISEN VOM BILD B.

## ES

## INSTRUCCIONES DE MONTAJE

POSICIONAR LOS SOPORTES 1 COMO SE ILUSTRAN EN LA IMAGEN "A" Y EJECUTAR EL MONTAJE PROPUESTO. EN EL CASO EN QUE SOBRE LA MOTO NO HAYA SIDO MONTADO EL MONORACK 351FZ, POSICIONAR LAS ARANDELAS "17" ENTRE EL SOPORTE "1" Y EL AGUJERO SOLDADO SOBRE EL 351 KIT. FIJAR EL PORTAMALETAS A LAS ESTRIBERAS SIGUIENDO EL MONTAJE PROPUESTO EN FIGURA "B".