

ATTACCHI SPECIFICI PER - SPECIFIC FITTING KIT FOR
 KIT DE MONTAGE SPECIFIQUE POUR - SPEZIFISCHER MONTAGEKIT FÜR
 ANCLAJE ESPECIFICO PARA

KIMCO Grand Dink 150/200 00/02

ISTRUZIONI DI MONTAGGIO - MOUNTING INSTRUCTIONS
 INSTRUCCIONES DE MONTAJE - BAUANLEITUNG - INSTRUCCIONES DE MONTAJE

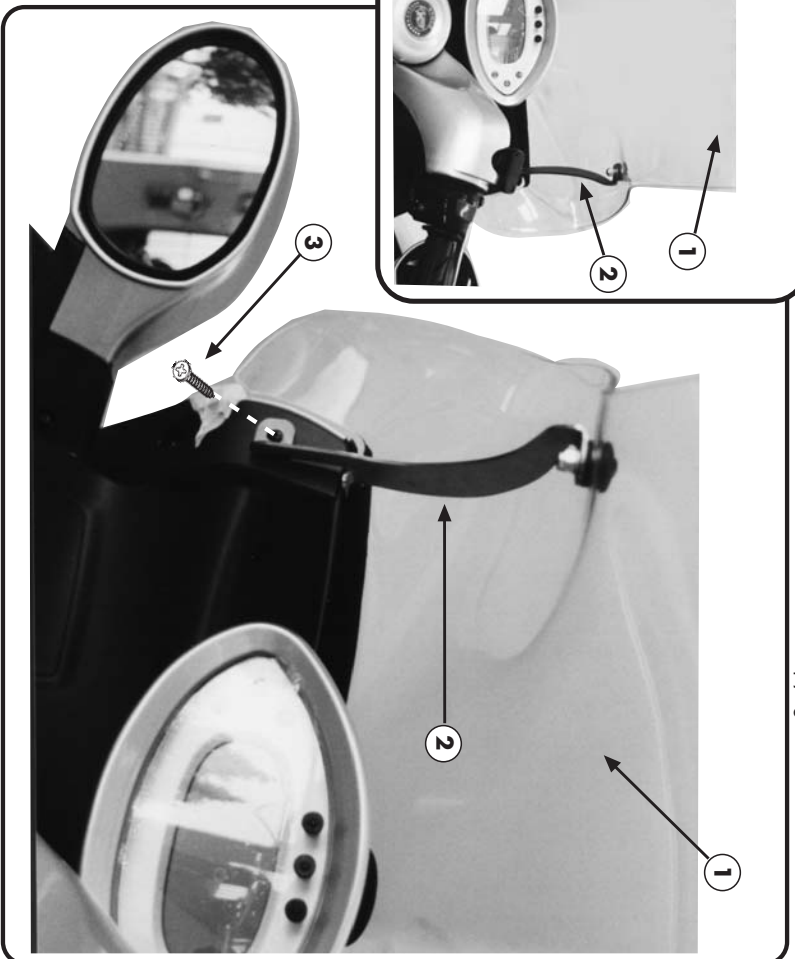
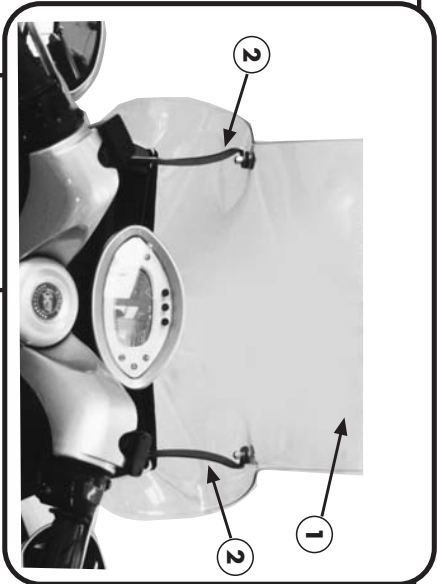
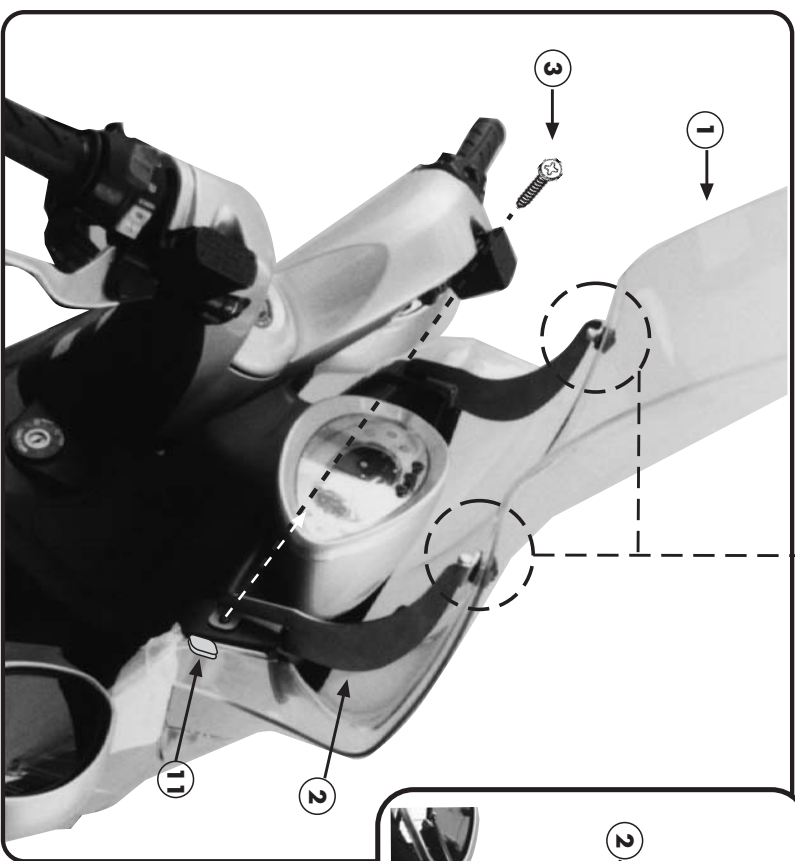
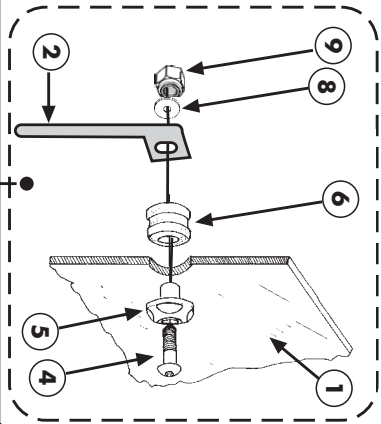
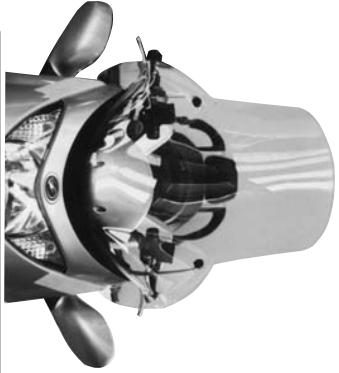

1

Q.TY n.1

2

SUPPORTO NERO
 SUPPORT
 LAGER
 SOPORTE
Q.TY n.2 dx-sx

3

VITE TCTC 4.3X22 nero
 SCREW M 4,3X22
 VIS M 4,3X22
 SCHRAUBE M 4,3X22
 TORNILLO M 4,3X22
Q.TY n.2

4

VITE TBEI M6x25 nero
 SCREW M6x25
 VIS M6x25
 SCHRAUBE M6x25
 TORNILLO M6x25
Q.TY n.2

5

BOCCOLA RITENZIONE
 NYLON CAP
 BOUCHON NYLON
 NYLONRÜCHSE ZUR
 FIXIERUNG DER
 GLASSCHIBE
 CASQUILLA
Q.TY n.2

6

PASSACAVO Z268
 FARIERADDER
 CHAUMARD
 GUMMWITZLE
 FUNDA
Q.TY n.2

7

RONDELLA GOMMA Ø16x3 F66,5
 WASHER 16
 RONDELLE 16
 SCHEIBE 16
 ARANDELA 16
Q.TY n.2

8

RONDELLA Ø6
 WASHER 16
 RONDELLE 16
 SCHEIBE 16
 ARANDELA 16
Q.TY n.2

9

DADO M 6 A.B.NERO
 M6 BOLT
 ECROU M6
 MUTTER M6
 TÜRCA M6
Q.TY n.2

10

MOUSSE Z298
 RUBBER
 MOUSSE
 GUMMI
 MOUSSE
Q.TY n.2