

A307A - A307A

ATTACCHI SPECIFICI PER - SPECIFIC FITTING KIT FOR  
KIT DE MONTAGE SPECIFIQUE POUR - SPEZIFISCHER MONTAGEKIT F R  
ANCLAJE ESPECCEFICO PARA

# HONDA SH 300i 2007

ISTRUZIONI DI MONTAGGIO - MOUNTING INSTRUCTIONS  
INSTRUCTIONS DE MONTAGE - BAUANLEITUNG - INSTRUCCIONES DE MONTAJE

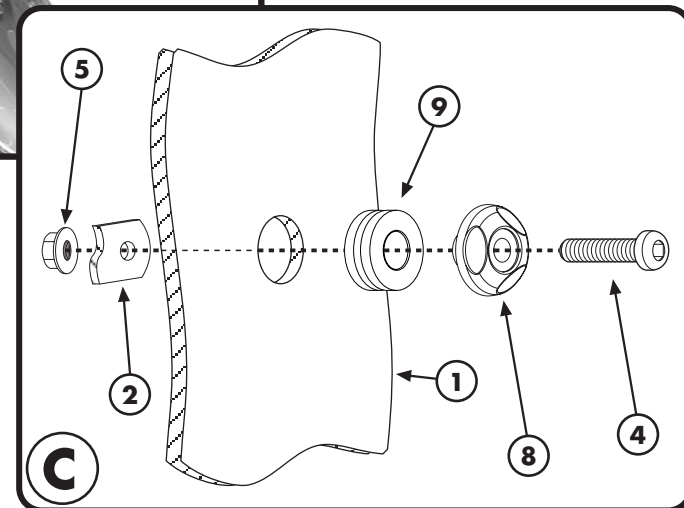
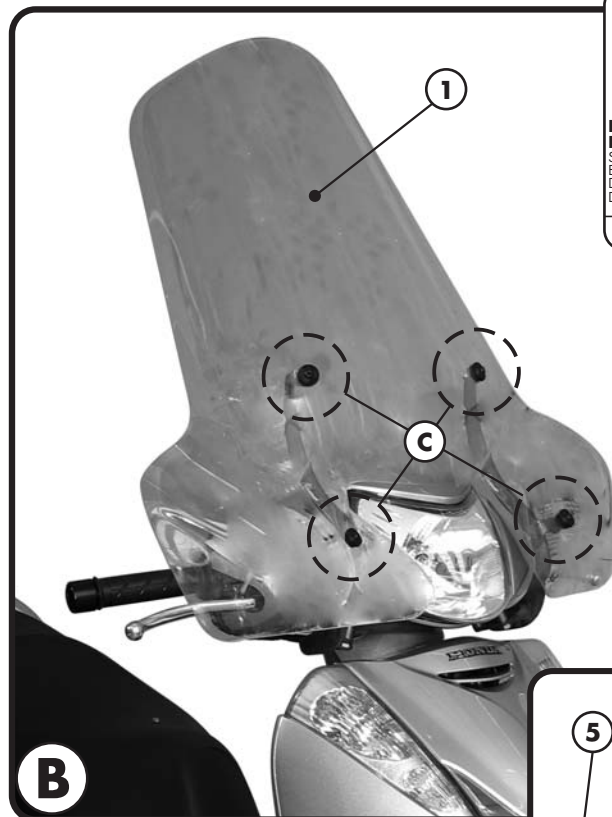
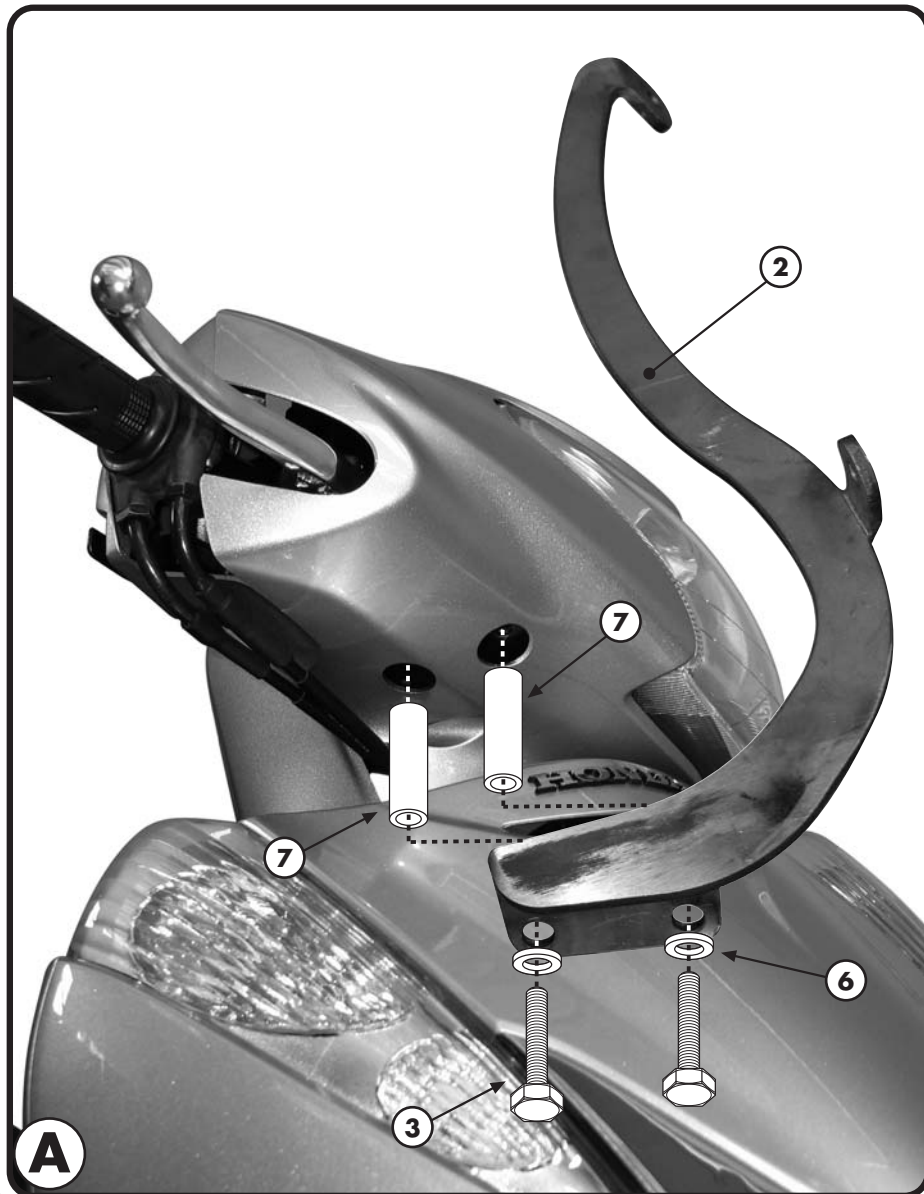
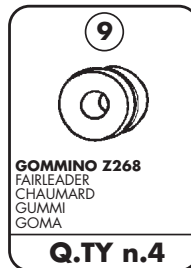
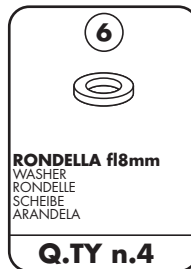
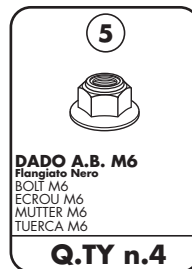
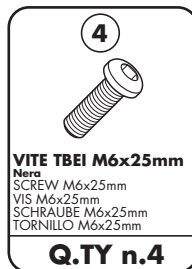
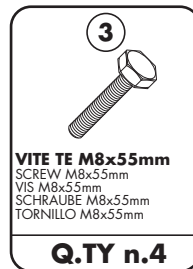
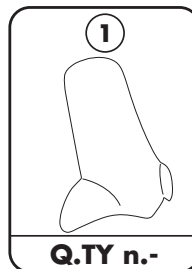

ATTACCHI SPECIFICI PER - SPECIFIC FITTING KIT FOR  
KIT DE MONTAGE SPECIFIQUE POUR - SPEZIFISCHER MONTAGEKIT F R  
ANCLAJE ESPECCEFICO PARA

# HONDA SH 300i 2007

ISTRUZIONI DI MONTAGGIO - MOUNTING INSTRUCTIONS  
INSTRUCTIONS DE MONTAGE - BAUANLEITUNG - INSTRUCCIONES DE MONTAJE

## I ISTRUZIONI DI MONTAGGIO

1. MONTARE I SUPPORTI N°2 COME INDICATO IN FOTOGRAFIA A;
2. MONTARE IL PARABREZZA (NON INCLUSO) COME INDICATO IN FOTOGRAFIA B FACENDO RIFERIMENTO ALL'IMMAGINE C;
3. ULTIMARE IL MONTAGGIO CONTROLLANDO CHE LE VITI SIANO SERRATE BENE.

## GB MOUNTING INSTRUCTIONS

1. MOUNT THE SUPPORTS N° 2 AS SHOWN IN PICTURE A;
2. MOUNT THE WINDSCREEN (NOT INCLUDED) AS SHOWN IN PICTURE B AND ALSO MAKING REFERENCE TO PICTURE C;
3. LASTLY CHECK THAT ALL SCREWS HAVE BEEN TIGHTENED.

## F INSTRUCTIONS DE MONTAGE

1. DEMONTER LES SUPPORTS N.2 COMME INDIQUE EN PHOTO A;
2. MONTER LE PARE-BRISE (PAS INCLUS) COMME INDIQUE EN PHOTO B EN SE REFERANT A L'IMMAGE C ;
3. TERMINER LE MONTEGE EN CONTROLANT LE BON SERRAGE DE TOUTES LES VIS.

## D BAUANLEITUNG

1. MONTIEREN SIE DIE HALTERUNGEN NR. 2 WIE IM BILD A BESCHRIEBEN;
2. MONTIEREN SIE DAS WINSCHILD (NICHT VORHANDEN) WIE IM BILD A BESCHRIEBEN UND NEHMEN SIE BEZUG AUF BILD C.
3. ZULETZT ÜBERPRÜFEN SIE, DASS ALLE SCHRAUBEN FESTGEZOGEN WURDEN.

## ES

## INSTRUCCIONES DE MONTAJE

1. MONTAR LOS SUPORTES COMO INDICADO EN LA FOTOGRAFIA "A";
2. MONTAR EL PARABRISAS (NO INCLUIDO) COMO EN LA FOTOGRAFIA "B", HACE REFERENCIA A LA IMAGEN "C";
3. FINALIZAR EL MONTAJE ASEGURANDESE DE QUE TODOS LOS TORNILLOS ESTEN BIEN APRETADOS.